

## CHECKOUT FEATURES:

- STAINLESS STEEL BAGGER SURFACE
- BUMPER MOLDING
- CRUMB TRAY
- UTILITY DRAWER IN PRINTER STAND
- LAMINATE THROUGH-OUT
- 18" X 36" EXPOSED CONVEYOR SYSTEM WITH FOOT PEDAL
- STAINLESS STEEL TRIMMED SCANNER AREA
- STAINLESS STEEL FOOTGUARDS
- STAINLESS STEEL TRIMMED ACCENT PANELS
- PAINTED BLACK METAL BASES
- ACRYLIC CHECKWRITING PAD

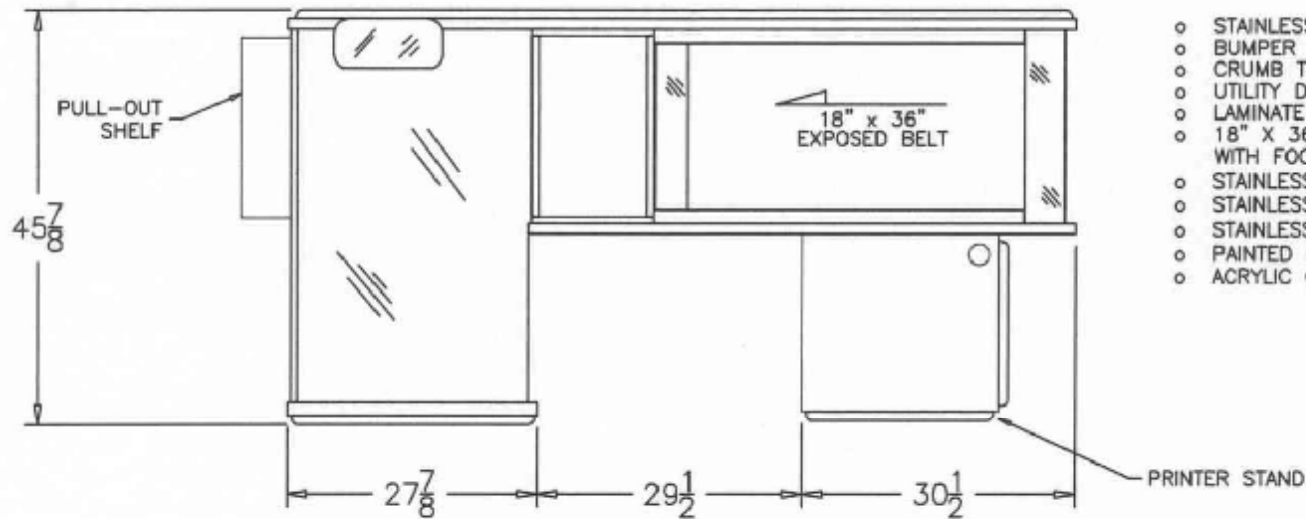

TOP VIEW

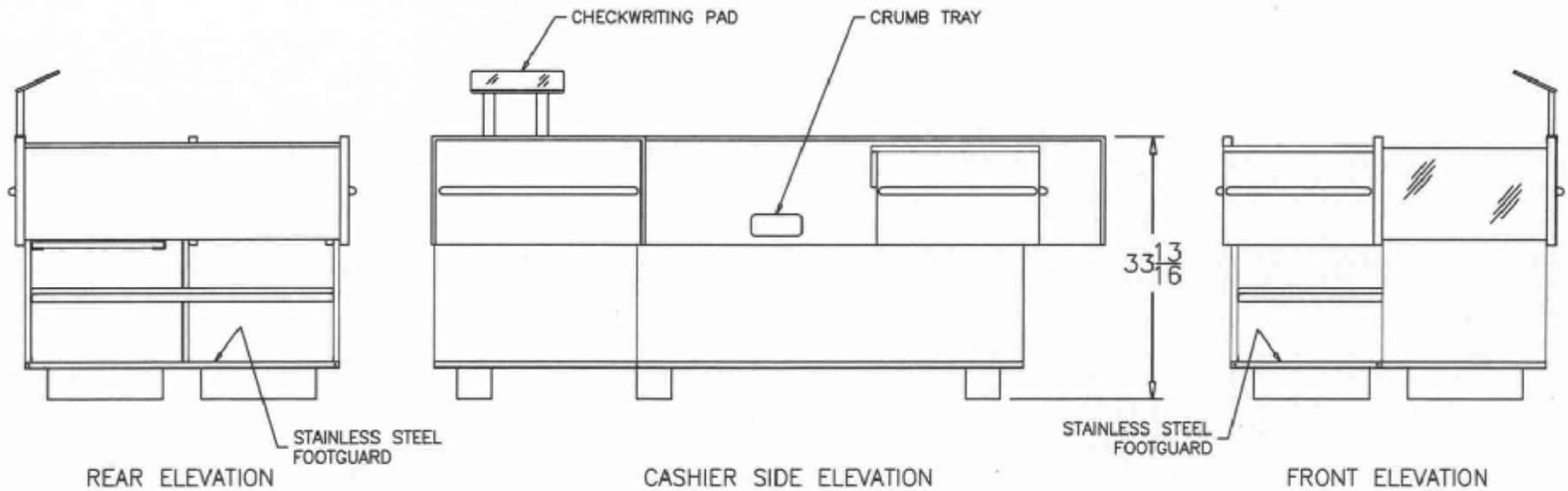

REAR ELEVATION

CASHIER SIDE ELEVATION

FRONT ELEVATION